

TURNBUCKLE WALL TOGGLE

UNF THREAD, 316 STAINLESS STEEL



Import



Precision
Machined



Stamped

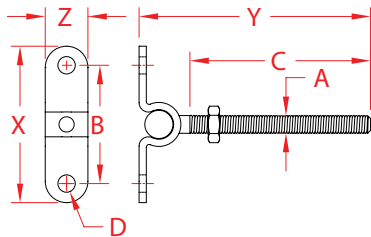

ITEM	A (size)	B	C	D	X (height)	Y (length)	Z (width)	WT (lb)	PACKAGING TYPE	EACH (qty)	INNER (qty)	CARTON (qty)	UPC
LEFT HAND, UNC													
P0776-WT07	1/4"	1.62"	2.40"	0.24"	2.16"	2.98"	0.60"	0.09	POLYBAG	1	25	350	791506025870
P0776-WT09	5/16"	2.00"	2.52"	0.31"	2.80"	3.29"	0.78"	0.16	POLYBAG	1	25	200	791506025887
P0776-WT10	3/8"	2.22"	2.65"	0.39"	3.10"	3.61"	0.86"	0.23	POLYBAG	1	25	150	791506025894

NOTE:

**USE WITH "CLOSED" TURNBUCKLE BODY (P0780-BD). REFERENCE "FASTENER MATCHING CHART" FOR COMPATIBLE FASTENERS.
ALL DIMENSIONS ARE NOMINAL (+/- 3%) AND ARE SUBJECT TO CHANGE WITHOUT NOTICE.**